

## 1470 nm / 980 nm Multi-Wavelength Detachable Laser Diode

KD030H015A5CC-Y1Y



### Features:

- Multiple wavelength
- Multiple function
- 200μm fiber detachable
- 0.22NA

### Applications:

- Medical use
- Scientific research

### Additional Functions:

- Aiming beam
- Fiber & Power monitor
- Thermistor
- Replaceable window panels (optional)

Specifications ( 25°C )		Symbol	Unit	KD030H015A5CC-Y1Y		
				Minimum	Typical	Maximum
980 <sup>(1)</sup>	CW Output Power	P <sub>o</sub>	W	30	-	-
	Center Wavelength	λ <sub>c</sub>	nm	980±10		
	Threshold Current	I <sub>th</sub>	A	-	1.0	-
	Operating Current	I <sub>op</sub>	A	-	12	13
	Operating Voltage	V <sub>op</sub>	V	-	5	6
1470 <sup>(1)</sup>	CW Output Power	P <sub>o</sub>	W	15	-	-
	Center Wavelength	λ <sub>c</sub>	nm	1470±20		
	Threshold Current	I <sub>th</sub>	A	-	0.2	-
	Operating Current	I <sub>op</sub>	A	-	8	9
	Operating Voltage	V <sub>op</sub>	V	-	9.0	10.5
Thermistor	-	R <sub>t</sub>	(KΩ)/(25°C)		10±3%	
980 PD	-	PD	μA	100	-	3000
1470 PD	-	PD	μA	100	-	1000
Fiber Data	Core Diameter	D <sub>core</sub>	μm	-	200	-
	Numerical Aperture	NA	-	-	0.22	-
	Fiber Connector	-	-	-	SMA905	-
Others	ESD	V <sub>esd</sub>	V	-	-	500
	Storage Temperature <sup>(2)</sup>	T <sub>st</sub>	°C	-20	-	70
	Lead Soldering Temp	T <sub>ls</sub>	°C	-	-	260
	Lead Soldering Time	t	sec	-	-	10
	Operating Case Temperature <sup>(3)</sup>	T <sub>op</sub>	°C	20	-	30
	Relative Humidity	RH	%	15	-	75
Aiming Beam	Output Power	P <sub>a</sub>	mW	2	-	-
	Wavelength	λ <sub>a</sub>	nm	635±10		
	Voltage	V <sub>a</sub>	V	5V(Constant)		

(1) Data measured under operation temperature @25°C.

(2) A non-condensing environment is required for operation and storage.

(3) Operating temperature defined by the package case. Acceptable operating range is 20°C~30°C, but performance may vary.

## Package Dimensions (mm)

## 1470 nm / 980 nm Multi-Wavelength Detachable Laser Diode

KD030H015A5CC-Y1Y

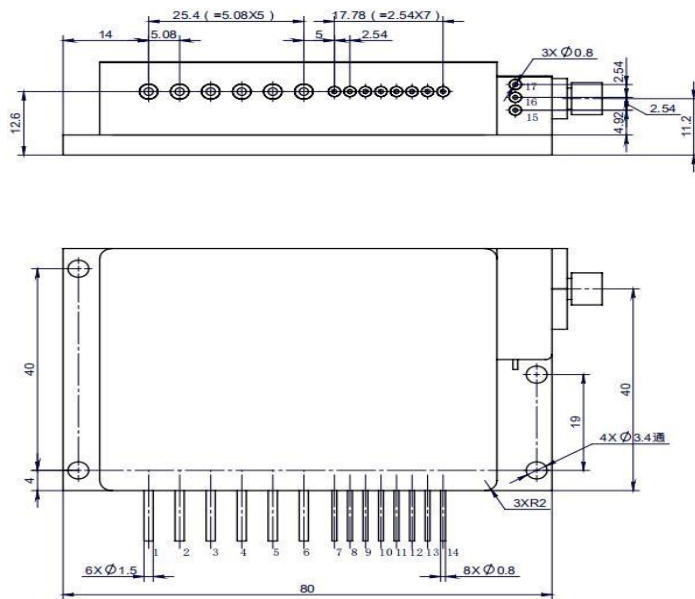

Pin	Function
1	980LD (+)
2	980LD (-)
3	-
4	-
5	1470LD(+)
6	1470LD(-)
7	Aiming Beam(5V)
8	Aiming Beam(0)
9	Thermistor

## OPERATING NOTES

- Avoid eye and skin exposure to direct radiation during operation.
- ESD precautions must be taken during storage, transportation and operation.
- Short-circuit is required between pins during storage and transportation.
- Soldering point should be close to the middle of the pins. Soldering temperature should be lower than 260°C and time shorter than 10 second.
- Make sure the fiber output end is properly cleaned before operation of laser. Follow safety protocols to avoid injury when handling and cutting the fiber.
- Laser diode must work with good cooling.
- Operation temperature ranges from 20°C to 30°C.
- Storage temperature ranges from -20°C to +70°C.